

Blindspace® S100X100SS [3.94x3.94"]
for Standard Roller Blind

HEAD BOX S100x100SS

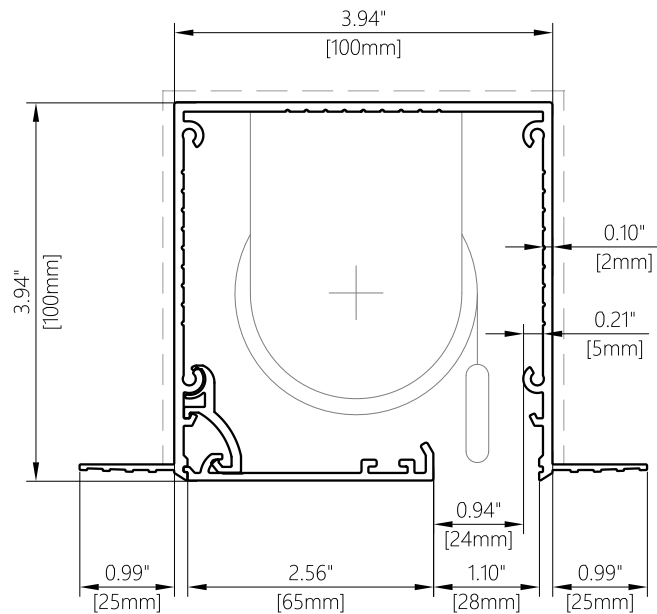

SIDE BOX S100x50SS (OPTIONAL)

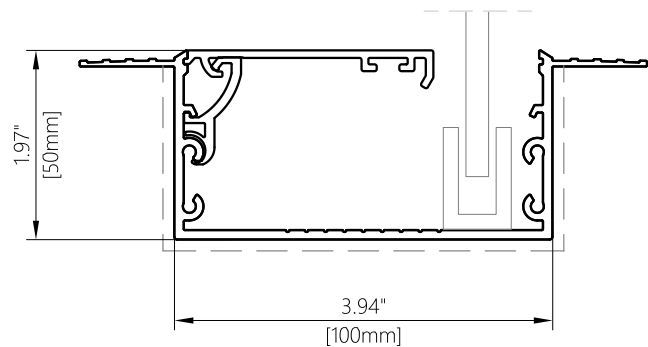

HEM BAR BOX S100x50SS (OPTIONAL)

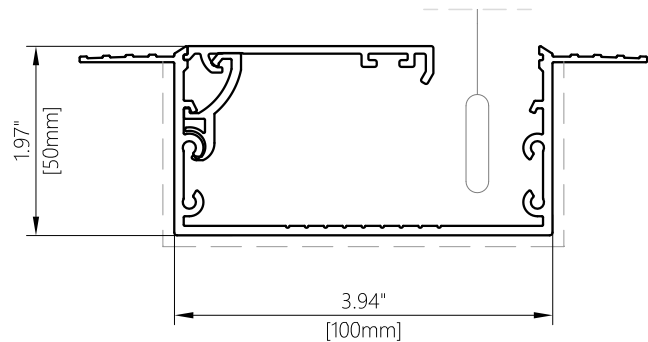

6"-1' scale

PRODUCT REFERENCE

S100x100SS

SERIES SIZE CORNERS

CONCEALMENT CONFIGURATION OPTIONS



Head Box



Head Box
+ Side Boxes



Head Box
+ Side Boxes
+ Hem Bar Box

BOX VARIATIONS

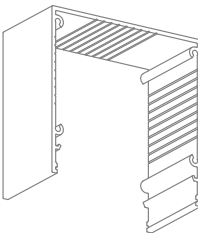

S100x100NN
No Flanges

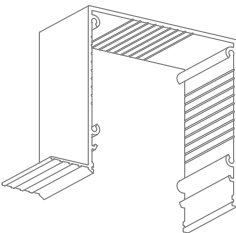

S100x100NS
Skim Coat Flange
on one side
(reversible)

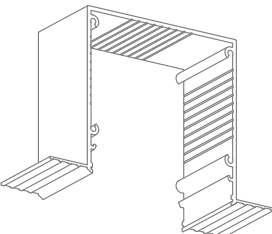

S100x100SS
Skim Coat Flange
on both sides

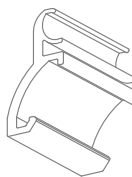

COVER HINGE
to hold cover plate,
installed on either side

Product	Blindspace S100X100SS [3.94x3.94"], S100X50SS [3.94x1.97"]
Description	Recessed box with optional flanges and hinged cover to conceal blinds flush with wall or ceiling finished surface.
Blind sizes	Please see size chart and supplier details for blind sizes such as max. width, height and area.
Finishes	Provided in RAL 9016 (white) Optional powder coating to other RAL colours available.
Material	Powder Coated Aluminium, EN 6063 T6
Optional accessories	End cap Splice pin (to align boxes) Splice plate (to align covers) Chain guide (for manual blinds) Covers in various widths
Box length	19'-8.2"[6000mm] Cut to size for shorter lengths. Spliced together for longer lengths.
Installation	Boxes to be fixed with countersunk screws every 7.87" [200mm] through back (and both flanges when available) into appropriate backing. Scrim tape to be used on flanges. Finished plaster level to be flush with cover. Allow 0.12" [3mm] recess space for ease of installation, shown in dash line around boxes
Print date	2023/06/14
Page size	ANSI B 11x17"
Print file	blindspace s100x100ss with standard roller blind [inch].dwg

Blindspace® S130X130SS [5.12x5.12"]
for Large Roller Blind

HEAD BOX S130x130SS

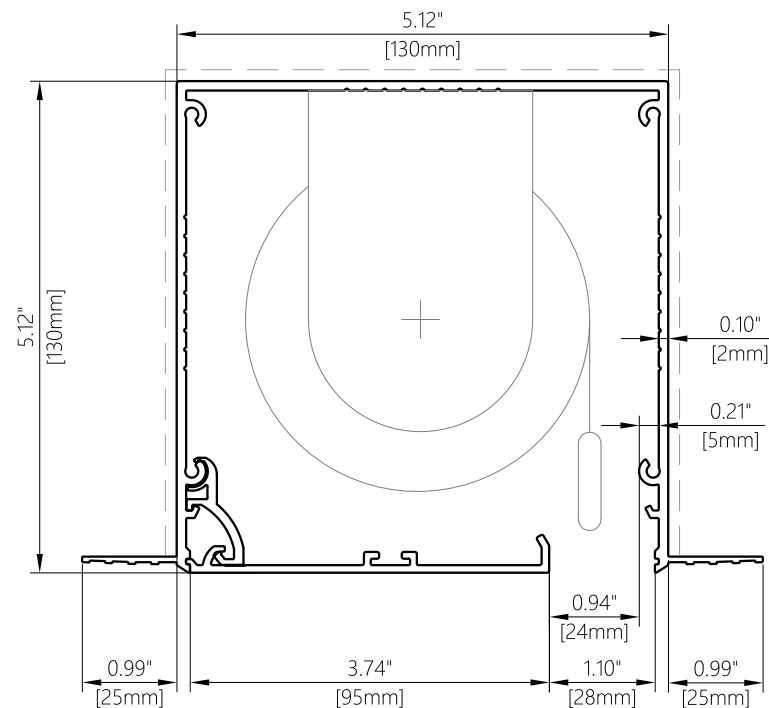

SIDE BOX S130x50SS (OPTIONAL)

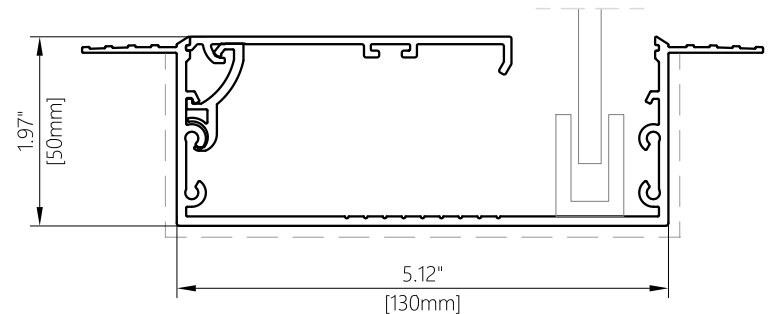

HEM BAR BOX S130x50SS (OPTIONAL)

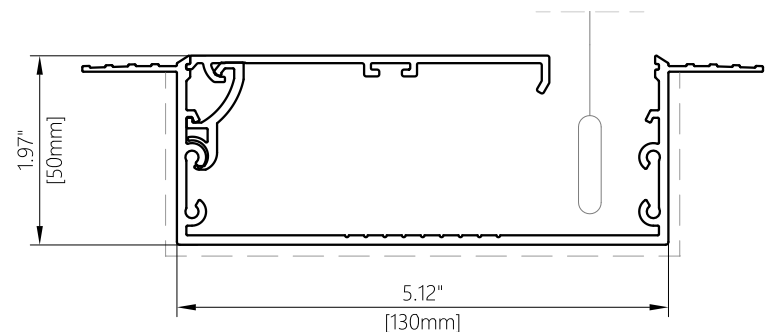

6"-1' scale

PRODUCT REFERENCE

S130x130SS
SERIES SIZE CORNERS

CONCEALMENT CONFIGURATION OPTIONS

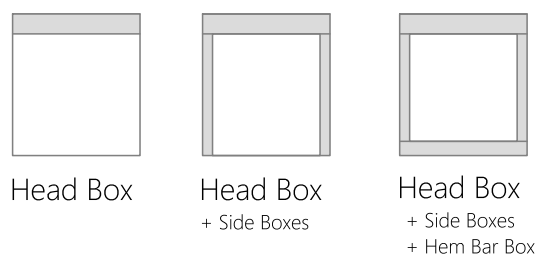

BOX VARIATIONS

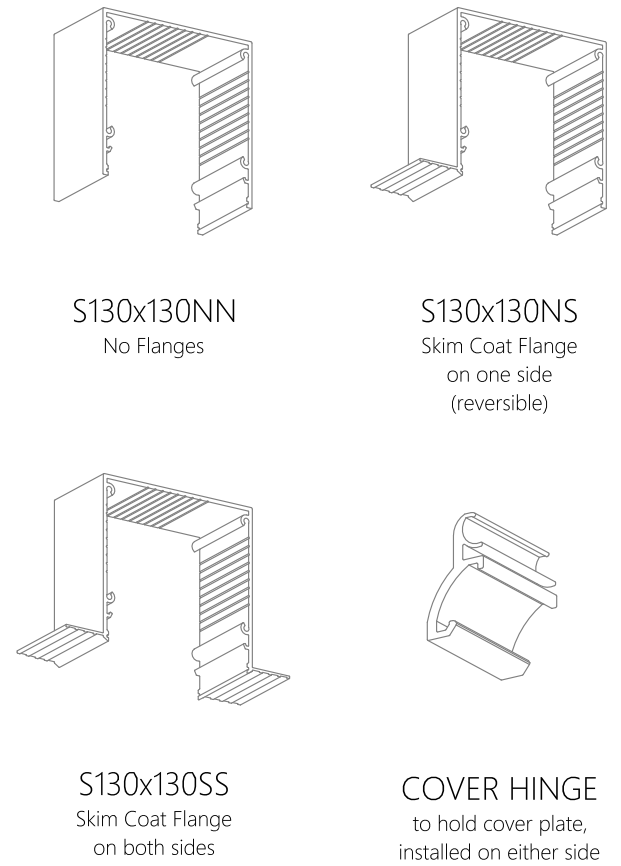

Product	Blindspace S130X130SS [5.12x5.12"], S130X50SS [5.12x1.97"]
Description	Recessed box with optional flanges and hinged cover to conceal blinds flush with wall or ceiling finished surface.
Blind sizes	Please see size chart and supplier details for blind sizes such as max. width, height and area.
Finishes	Provided in RAL 9016 (white) Optional powder coating to other RAL colours available.
Material	Powder Coated Aluminium, EN 6063 T6
Optional accessories	End cap Splice pin (to align boxes) Splice plate (to align covers) Chain guide (for manual blinds) Covers in various widths
Box length	19'-8.2"[6000mm] Cut to size for shorter lengths. Spliced together for longer lengths.
Installation	Boxes to be fixed with countersunk screws every 7.87" [200mm] through back (and both flanges when available) into appropriate backing. Scrim tape to be used on flanges. Finished plaster level to be flush with cover. Allow 0.12" [3mm] recess space for ease of installation, shown in dash line around boxes
Print date	2023/06/14
Page size	ANSI B 11x17"
Print file	blindspace s130x130ss with large roller blind [inch].dwg

Blindspace TrackTrim®
for CRESTRON CSS-DRAPERY Curtain Track with motor end and return end

MOTOR BOX TTCMB1F

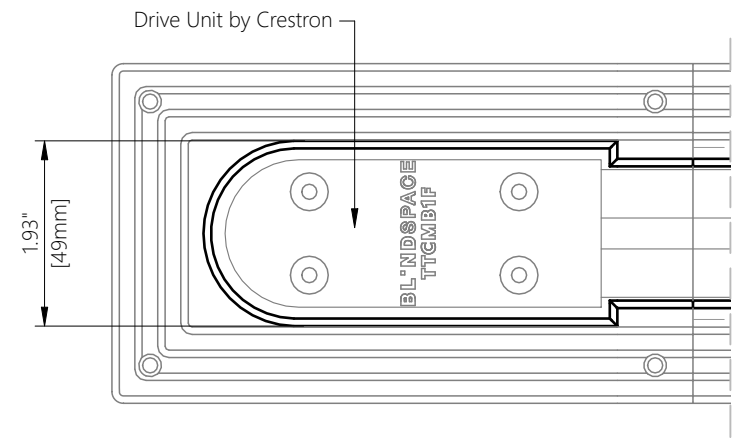

TRACK PROFILE TT1F/TT2F

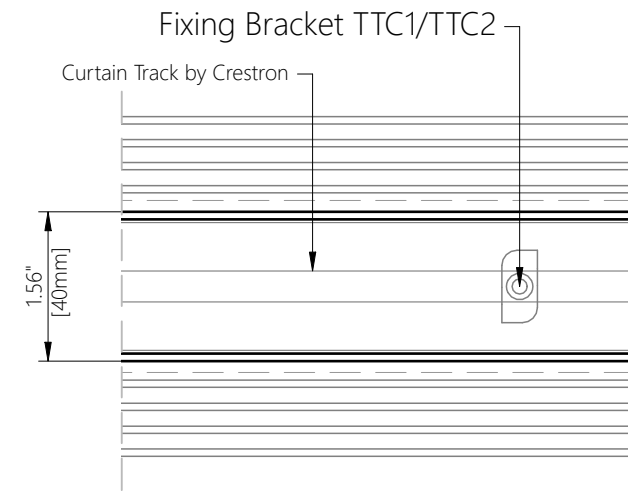

RETURN BOX TTCRB1F

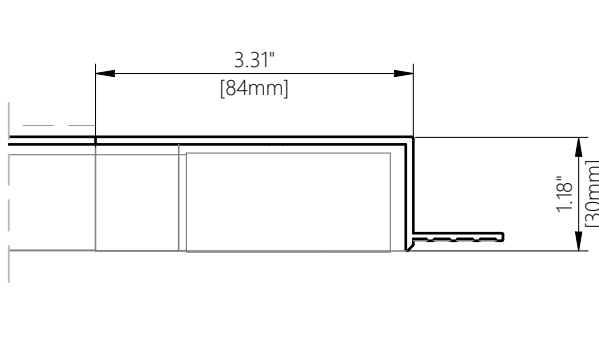
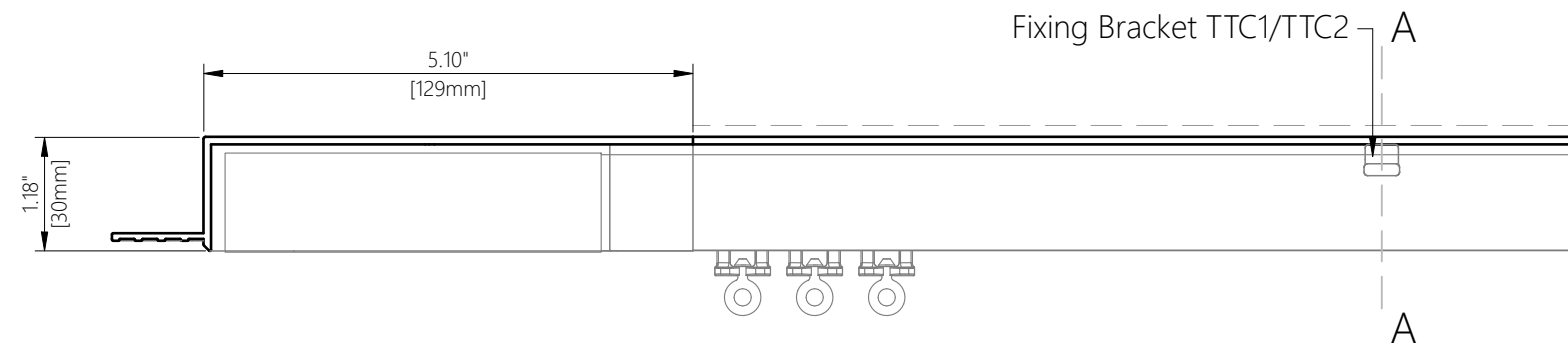
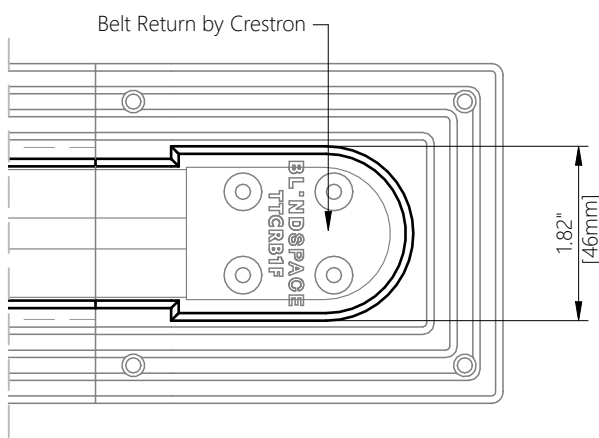

6"-1' scale

FIXING BRACKET

TTC1/TTC2 - Fixing Bracket

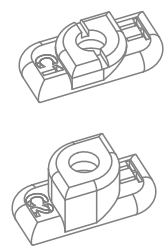

Fixing Brackets for drapery track,
TTC1 for TT1F TrackTrim profile ,
TTC2 for TT2F TrackTrim profile .

SECTION A-A TT1F PROFILE

TT1F – Track with Screw Channel, possible Screw-Through Fixing

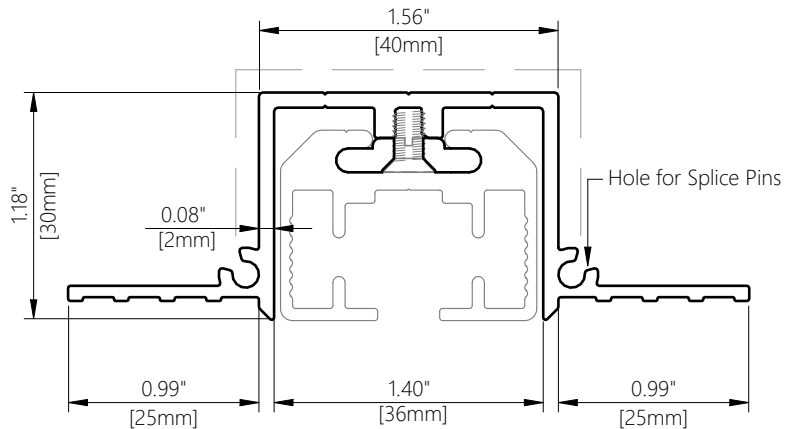

SECTION A-A TT2F PROFILE (OPTIONAL)

TT2F – Track for Screw-Through Fixing

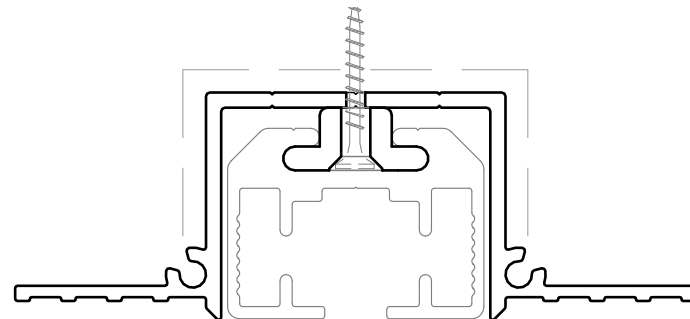

1"-1' scale full scale

Product	Blindspace TrackTrim
Description	Recessed profiles to house curtain tracks.
Curtain size	Please see size chart and supplier details for curtain such as max. length and weight.
Finishes	White to be plastered in and decorated at site to match ceiling.
Material	Track EN 6063 T6, End set PLA Thermoplastic Polyester
Optional accessories	Curve Sections for bent tracks Long Splice Pins for joining
Track length	6'-74" [2000mm] Cut to size for shorter lengths. Spliced together for longer lengths.
Installation	Please refer to Sample Installation Drawings available both in PDF and DWG at blindspace.com Tracks to be fixed with countersunk screws every 7.87" [200mm] through back (and both flanges when available) into appropriate backing. Scrim tape to be used on flanges. Finished plaster level to be flush with chamfered edge. Allow 0.12" [3mm] recess space for ease of installation, shown in dash line around tracks
Print date	2023/07/07
Page size	ISO A3 420x297
Print file	blindspace tracktrim with crst css [inch].dwg

Blindspace TrackTrim®
for LUTRON Sivoia Curtain Track

MOTOR BOX TTLIMB1F

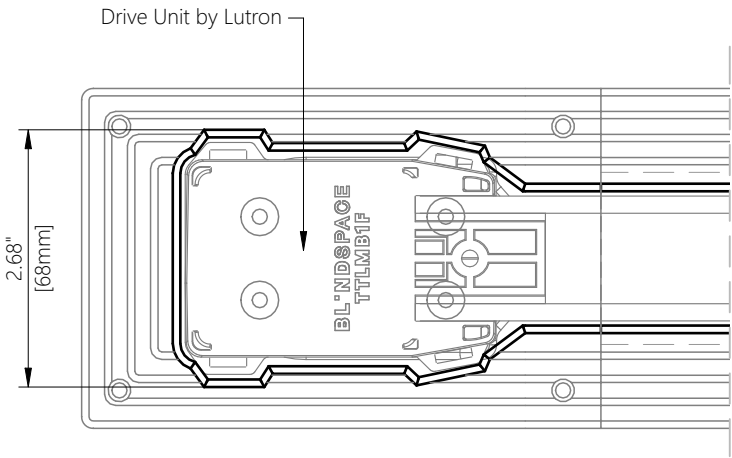

TRACK PROFILE TT1F/TT2F

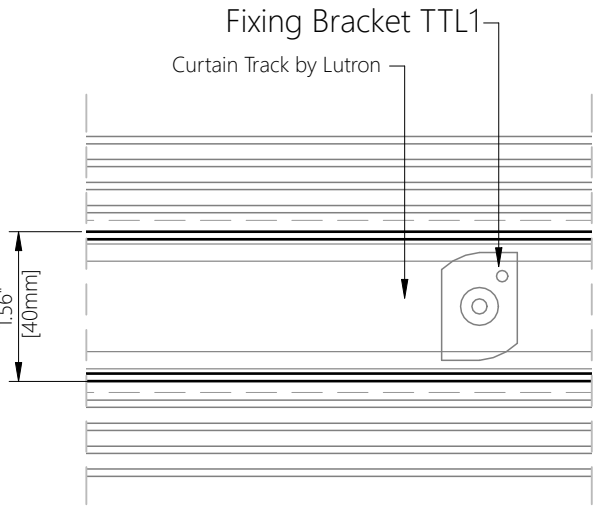

RETURN BOX TTLRB1F

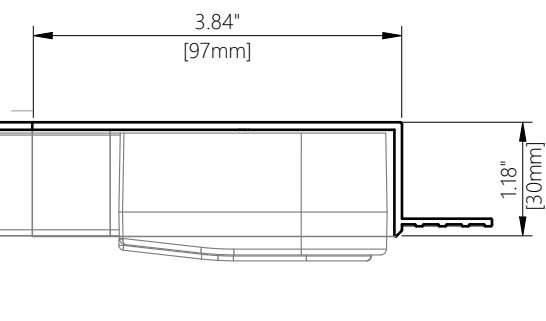
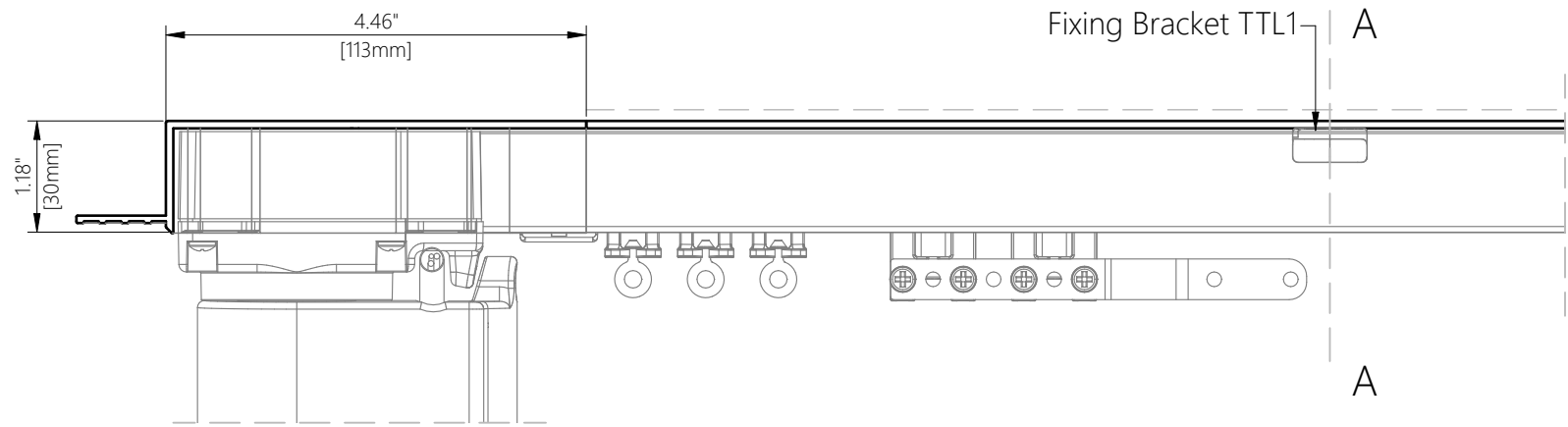
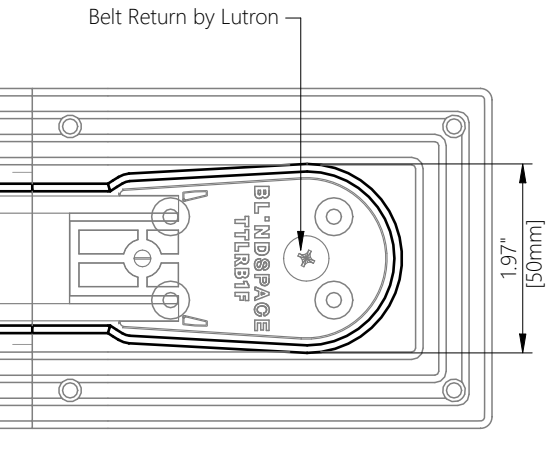

6"-1' scale

FIXING BRACKET

TT51 - Fixing Bracket

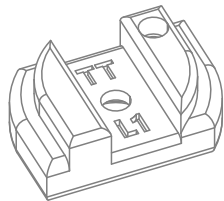

Fixing Bracket for drapery track
can be used with both types
TT1F & TT2F of TrackTrim profiles.

SECTION A-A TT1F PROFILE

TT1F – Track with Screw Channel, possible Screw-Through Fixing

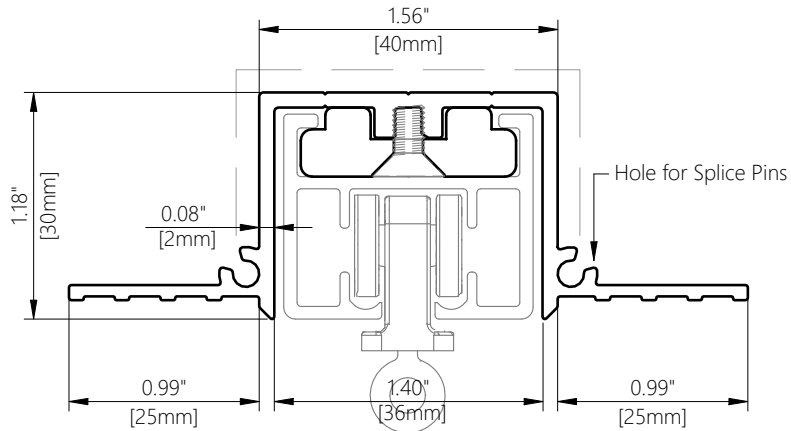

SECTION A-A TT2F PROFILE (OPTIONAL)

TT2F – Track for Screw-Through Fixing

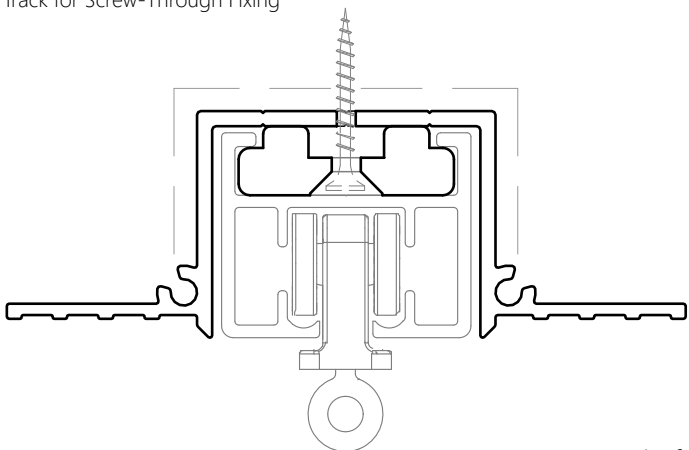

1"-1' scale full scale

Product	Blindspace TrackTrim
Description	Recessed profiles to house curtain tracks.
Curtain size	Please see size chart and supplier details for curtain such as max. length and weight.
Finishes	White to be plastered in and decorated at site to match ceiling.
Material	Track EN 6063 T6, End set PLA Thermoplastic Polyester
Optional accessories	Curve Sections for bent tracks Long Splice Pins for joining
Track length	6'-74" [2000mm] Cut to size for shorter lengths. Spliced together for longer lengths.
Installation	Please refer to Sample Installation Drawings available both in PDF and DWG at blindspace.com Tracks to be fixed with countersunk screws every 7.87" [200mm] through back (and both flanges when available) into appropriate backing. Scrim tape to be used on flanges. Finished plaster level to be flush with chamfered edge. Allow 0.12" [3mm] recess space for ease of installation, shown in dash line around tracks
Print date	2023/07/04
Page size	ISO A3 420x297
Print file	blindspace tracktrim with lutron sivoia [inch].dwg

Blindspace TrackTrim®
for SOMFY Glydea with motor end and return end

MOTOR BOX TTSMB1F

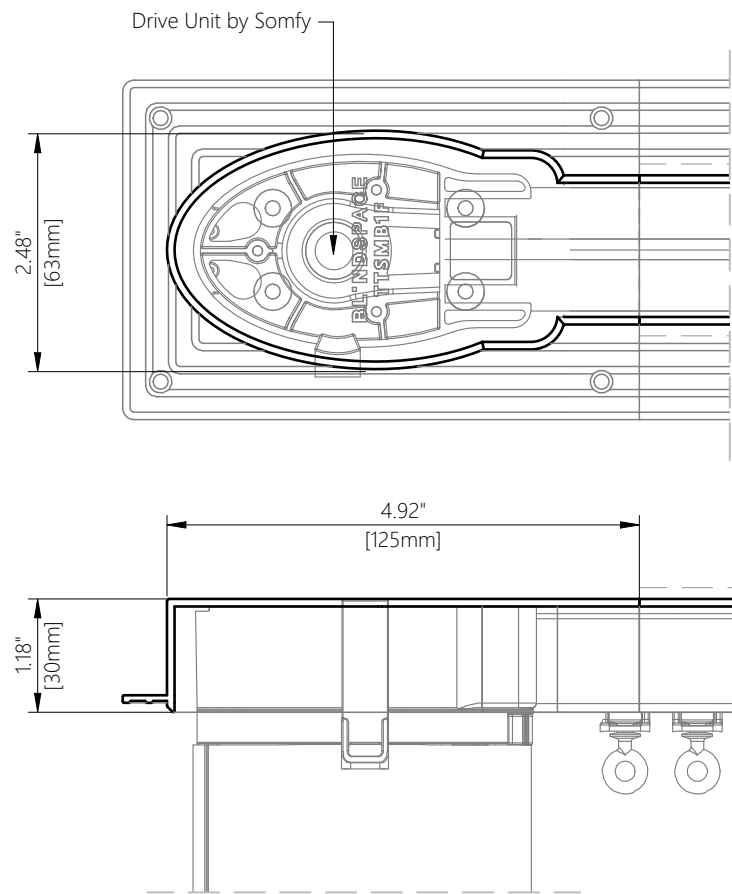

FIXING BRACKET

TTS1 - Fixing Bracket

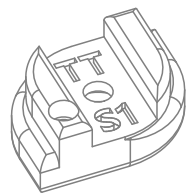

Fixing Bracket for drapery track
can be used with both types
TT1F & TT2F of TrackTrim profiles.

TRACK PROFILE TT1F/TT2F

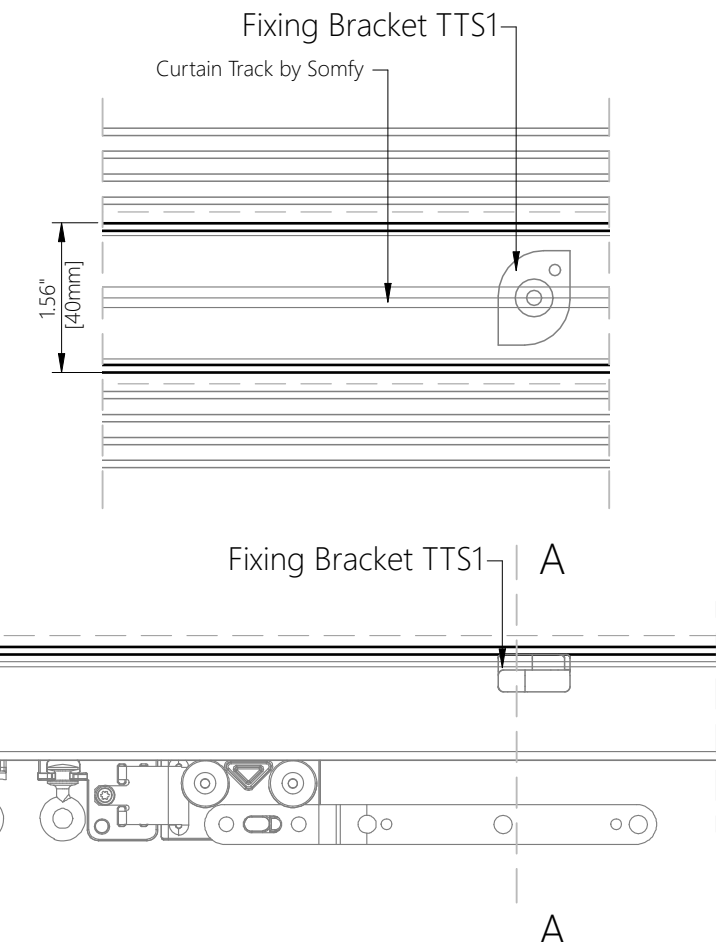

SECTION A-A TT1F PROFILE

TT1F – Track with Screw Channel, possible Screw-Through Fixing

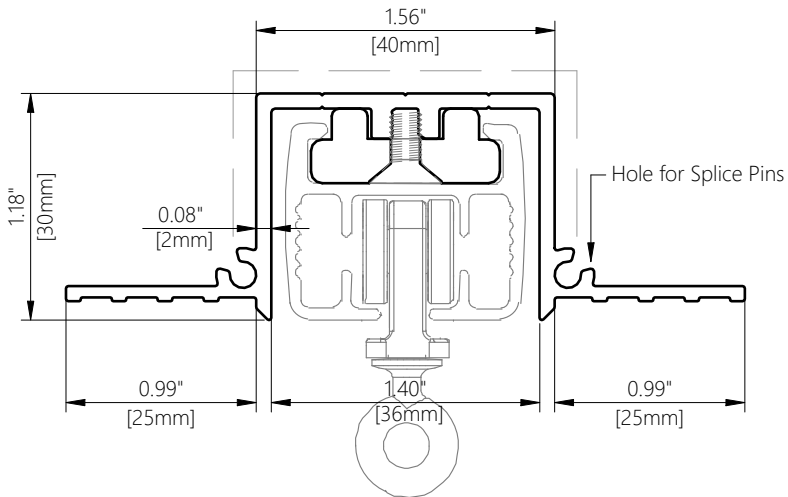

RETURN BOX TTSRB1F

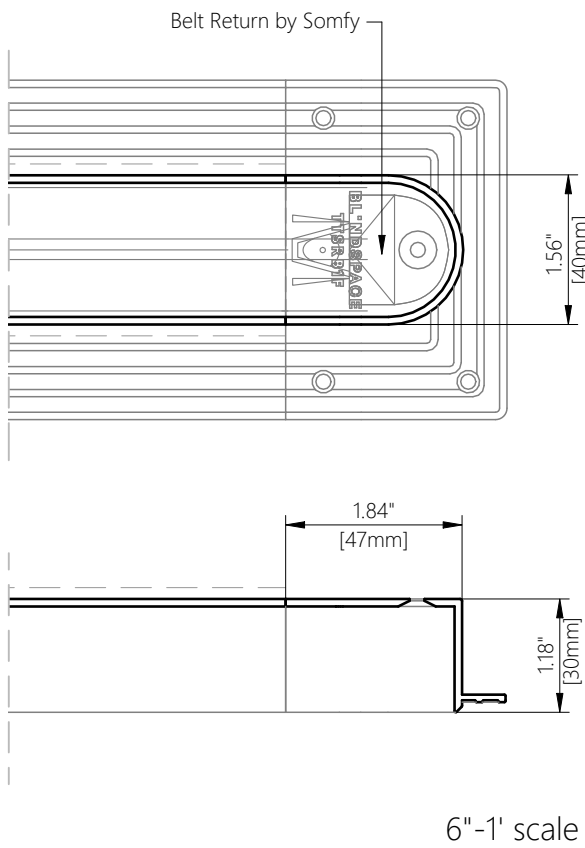

SECTION A-A TT2F PROFILE (OPTIONAL)

TT2F – Track for Screw-Through Fixing

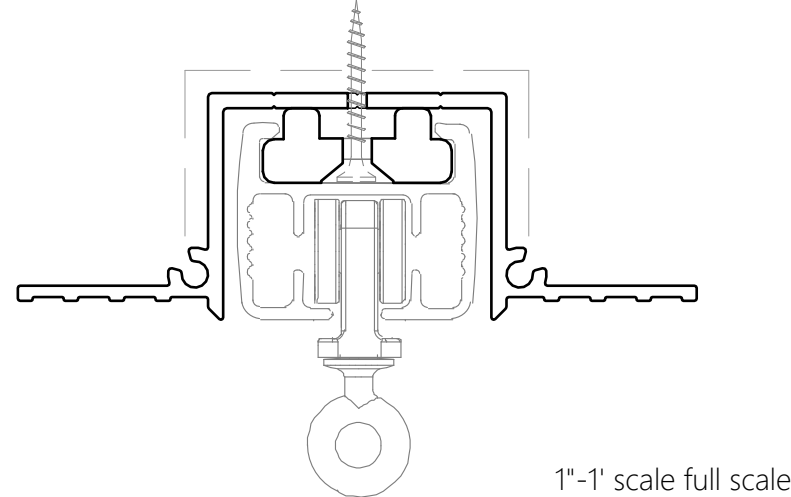

Product	Blindspace TrackTrim
Description	Recessed profiles to house curtain tracks.
Curtain size	Please see size chart and supplier details for curtain such as max. length and weight.
Finishes	White to be plastered in and decorated at site to match ceiling.
Material	Track EN 6063 T6, End set PLA Thermoplastic Polyester
Optional accessories	Curve Sections for bent tracks Long Splice Pins for joining
Track length	6'-74" [2000mm] Cut to size for shorter lengths. Spliced together for longer lengths.
Installation	Please refer to Sample Installation Drawings available both in PDF and DWG at blindspace.com Tracks to be fixed with countersunk screws every 7.87" [200mm] through back (and both flanges when available) into appropriate backing. Scrim tape to be used on flanges. Finished plaster level to be flush with chamfered edge. Allow 0.12" [3mm] recess space for ease of installation, shown in dash line around tracks
Print date	2023/06/27
Page size	ISO A3 420x297
Print file	blindspace tracktrim with somfy glydea [inch].dwg

Blindspace TrackTrim® R508
for recessed curved tracks with 20.0" [508mm] radius

TRACK CURVE SECTION R508

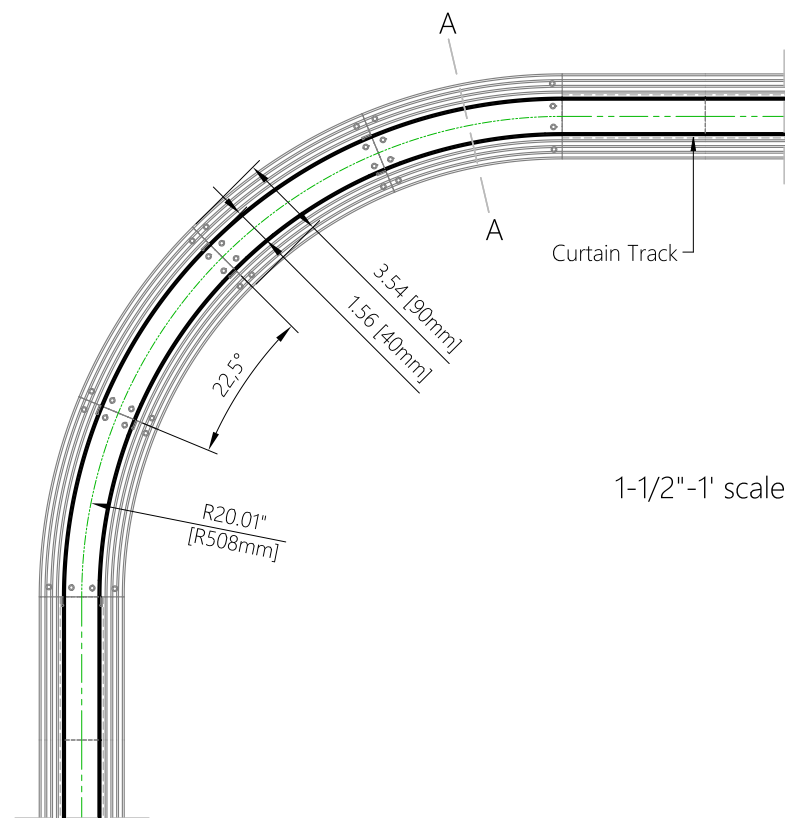

PRODUCT REFERENCE

TrackTrim®
R250

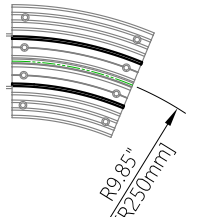

R9.85" [R250mm]

TrackTrim®
R290

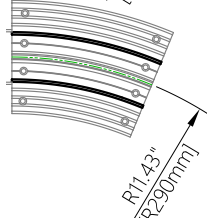

R11.43" [R290mm]

TrackTrim®
R300

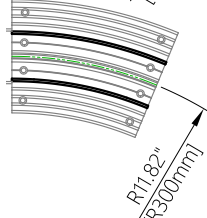

R11.82" [R300mm]

TrackTrim®
R330

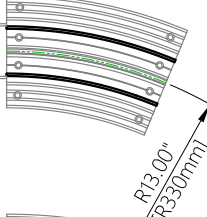

R13.00" [R330mm]

TrackTrim®
R365

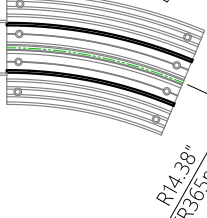

R14.38" [R365mm]

TrackTrim®
R440

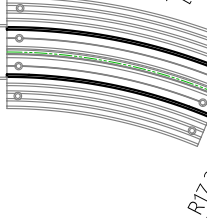

R17.34" [R440mm]

TrackTrim®
R480

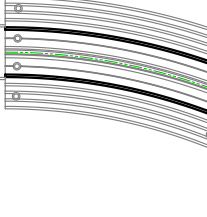

R18.91" [R480mm]

TrackTrim®
R508

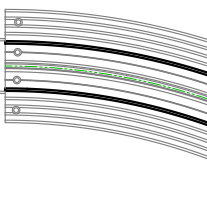

R20.0" [R508mm]

CAUTION: For further details and all possible configurations visit blindspace.com. For curtain stack sizes, please consult with curtain track specifications.

SECTION A-A

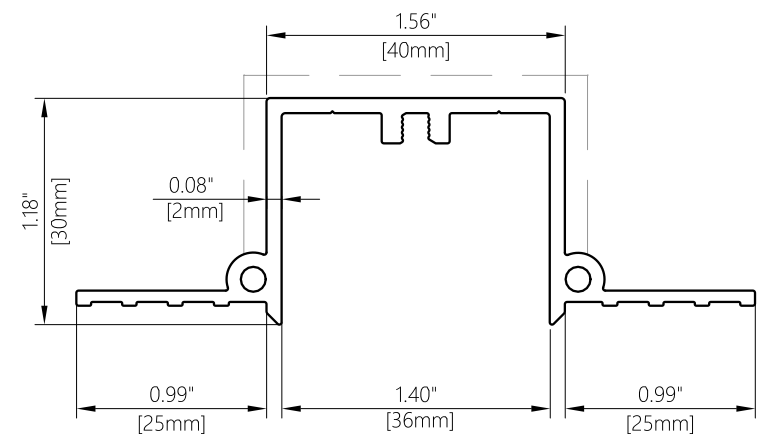

EXAMPLE CURVES

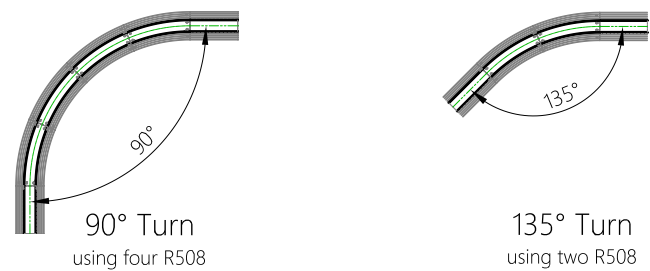

Product	Blindspace TrackTrim Curved Track Section
Description	Recessed profiles to house curtain tracks.
Curtain size	Please see size chart and supplier details for curtain such as max. length and weight.
Finishes	White to be plastered in and decorated at site to match ceiling.
Material	PETG Polyethylene Terephthalate
Installation	<p>Please refer to Sample Installation Drawings available both in PDF and DWG at blindspace.com</p> <p>Tracks to be fixed with countersunk screws using holes through back and both flanges into appropriate backing.</p> <p>Scrim tape to be used on flanges.</p> <p>Finished plaster level to be flush with chamfered edge.</p> <p>Allow 0.12" [3mm] recess space for ease of installation, shown in dash line around tracks</p>
Print date	2024/01/15
Page size	ISO A3 420x297
Print file	blindspace tracktrim curved tracks r508 [inch].dwg